



THE CLIENT

Xenira – transform drug delivery challenges into opportunities by leveraging advanced lipid-based technologies that improve bioavailability, stability and therapeutic performance. Xenira’s formulation platforms help Pharmaceutical partners overcome solubility barriers, enhance drug stability and optimise patient outcomes. From concept to commercial scale, Xenira accelerate Pharmaceutical innovation through expert formulation development and integrated support.

THE BRIEF

The client required a relatively small ISO14644-compliant modular cleanroom to support with the extraction and packaging of CBD oil. Whilst the cleanroom did not initially need to conform to the requirements of EU GMP Annex 1, the solution was developed in such a way that it could easily be upgraded to meet those requirements in the future.

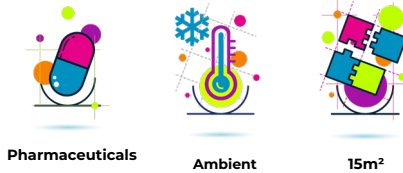

If you're based in the Nordics or Baltics and would like to discuss your Isopod enquiry, email sales@guardtech.com

“Great to see the Polish team shine in their territory”

Guardtech Nordic AB said: “Whilst this was a very straightforward modular cleanroom installation, it was still great to see our Polish-based Installation Engineers having such a positive impact in communicating with a client in that territory. “Across the Guardtech Nordic AB team, our Installation Engineers and consultants, we now boast a robust offering to cover any Nordic or Baltic territory with the same high-quality level of service.”

Guardtech
Nordic AB



PHARMA PACKAGING

Contact Us

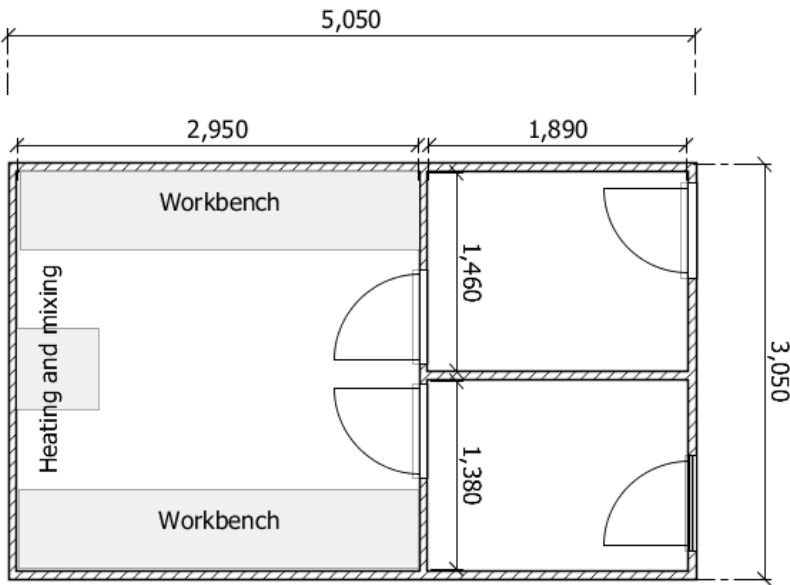

Guardtech House
Unit 1A Homefield Road,
Haverhill, CB9 8QP

0330 113 0303

sales@guardtech.com

www.guardtechgroup.com



THE TECH SPECS

A controlled environment designed, installed, cleaned and commissioned by Guardtech Nordic AB and built to the following specification:

- ◆ **Structural:**
GT Shell Plus Kingspan wall panel system, GT Lid Plus Kingspan ceiling panel system, GT Deck Plus vinyl flooring system – capped & coved, GT Access Plus single doors.
- ◆ **Mechanical:**
GT Flow Pro H14 HEPA fan filter units (FFUs) with gel seal and roomside change.
- ◆ **Electrical:**
GT Lux Plus LED lighting flush-mounted in ceiling panels with PIR sensor activation, 13amp sockets and double sockets wired back to distribution boards, 3-compartment curved profile trunking around room perimeter and columns, doors on electro-magnetic Kingspan interlock system.

THE CHALLENGES

Whilst this was a relatively straightforward modular cleanroom installation for the experienced Guardtech Cleanrooms team, they still worked as diligently as ever to produce an excellent three-suite facility on time and on budget in a professional and considerate manner.

Team effort: Because this was an international installation for Guardtech Nordic AB in Poland, there needed to be a strongly co-ordinated effort when it came to procurement, deliveries and shipping of materials to ensure a smooth operational process. The Guardtech Group Procurement Team did a particularly outstanding job to make what might've been a logistically complicated process very simple.

Great communication: The modular cleanroom may have been installed in Poland by the Guardtech Nordic AB team – who are based in Sweden – but due to the strong Polish contingent in our International Installation Team, all communication with the client

was excellent, contributing to a well-managed and well-co-ordinated project overall.

Future proof: The Guardtech Design Team ensured that whilst the cleanroom is technically an ISO8 installation, it boasts all the necessary components to be easily upgraded into a GMP Grade D cleanroom in the future. This is because the client had earmarked such a step in the ongoing development of their practices.

THE RESULT

Guardtech Nordic AB said:
"Whilst this was a very straightforward modular cleanroom installation, it was still great to see our Polish-based Installation Engineers having such a positive impact in communicating with a client in that territory."

"Across the Guardtech Nordic AB team, our Installation Engineers and consultants, we now boast a robust offering to cover any Nordic or Baltic territory with the same high-quality level of service and provision."